

REVISIONS		
NO.	DESCRIPTION	DATE

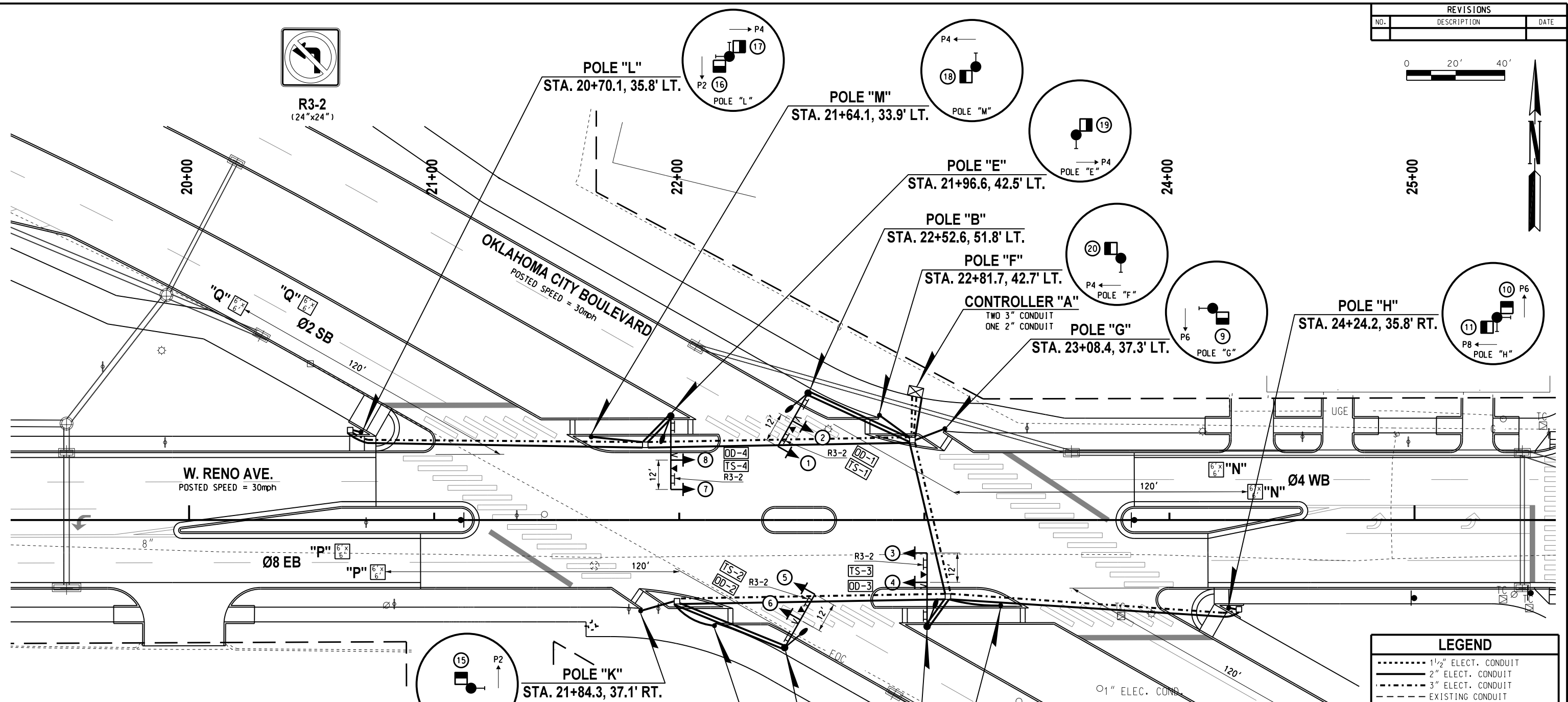
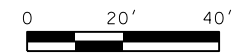

**TABLE # 1 SIGNAL HEADS**

SIGNAL HEAD NUMBER	NUMBER AND TYPE	MOUNTING	VISOR	BACKPLATE
1,2,3,4,5,6,7,8	8 - ONEWAY (S-6)	MAST ARM	V-1	SPECIAL
9,10,11,12,13,14,15,16,17,18,19,20	12 - ONEWAY (S-20)	CLAMP	V-3	SPECIAL

**TABLE # 2 MAST ARMS & POLES**

LOCATION	MOUNTING HT.	MAST ARMS LENGTHS	FOUNDATION
B	30'	25' T.S. & 10' LUM.	S-25
C	30'	30' T.S. & 10' LUM.	S-30
D	30'	25' T.S. & 10' LUM.	S-25
E	30'	30' T.S. & 10' LUM.	S-30
F,G,H,I,J,K,L,M	12'	8 - PED POLES	F-1

**TABLE # 3 ELECTRICAL CABLE**

ELECTRICAL CABLE TO CONTROLLER "A" LOCATION							
B-21C	C-21C/5C	D-21C	E-21C/5C	F-5C/5C	G-5C/5C	H-7C/5C	I-5C/5C
J-5C/5C	K-5C/5C	L-7C/5C	M-5C/5C				

**THERMAL TRAFFIC DETECTION NOTE:**  
THERMAL VEHICLE DETECTION WILL BE PROVIDED FOR THIS INTERSECTION. THE DETECTOR LOOPS SHOWN ON THE PAVEMENT ARE SHOWN ONLY TO DEPICT THE AREAS OF DETECTION FOR THE THERMAL DETECTION UNITS ALONG WITH THE PHASES THAT EACH THERMAL DETECTOR UNIT WILL CALL

**PUSH BUTTON NOTE:**  
THE POLE ENLARGEMENT DETAIL IS PROVIDED FOR INFORMATIONAL PURPOSES ONLY. THE PLACEMENT OF THE PEDESTRIAN PUSH BUTTONS AND SIGNAL HEADS SHALL BE INSTALLED ON THE POLES SUCH THAT THE SIGNAL HEADS ARE VISIBLE FROM THE CROSSWALK AND THE PUSH BUTTONS ARE ACCESSIBLE FROM THE ADJACENT SIDEWALK. THE HANDHOLE SHALL NOT CONFLICT WITH THE PUSH BUTTON LOCATIONS AS SHOWN.

**LEGEND**

- 1 1/2" ELECT. CONDUIT
- 2" ELECT. CONDUIT
- 3" ELECT. CONDUIT
- EXISTING CONDUIT
- SIZE 11 PULL BOX (UNLESS OTHERWISE NOTED)
- EXISTING PULL BOX
- SERVICE POLE
- CONTROLLER
- PEDESTRIAN PUSH BUTTON
- WALK AND DON'T WALK
- SIGNAL HEAD WITH BACKPLATE
- LUMINAIRE WITH MAST ARM
- OPTICAL DETECTOR
- FORWARD FACING INTERGRATED THERMAL TRAFFIC SENSOR
- STREET NAME SIGN
- MAST ARM WITH POLE
- SIGNAL HEAD NO.
- MAST ARM & POLE WITH ABOVE SYMBOLS
- DETECTOR LOOP/VIDEO DETECTION AREA



*R. Wayne Russell*  
R. WAYNE RUSSELL, P.E. # 16030  
C.A. # 1160, RENEWAL 06-30-19

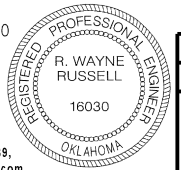

Design	RWR	08/08/17
Drawn	CCC	08/08/17

8-8-17  
DATE

Traffic Engineering Consultants, Inc.  
6000 S. Western, Suite 300 - Oklahoma City, OK 73139,  
Ph: 405-720-7721, Fax: 405-720-9848, Web: www.tecok.com



**SIGNAL PLAN**  
**W. RENO AVE. & OKLAHOMA CITY BOULEVARD**  
State Job No. 17428(88) Sheet No. 147

08/08/17 G:\OP\Projects\17428\17428A\_Downtown Blvd WP 5.B Task 5\CAD\BOULEVARD & RENO SIG.dgn